

SCHEDULE "A"

RECEIVED

SEP 13 2017
 SUBD 01880
 CITY OF NANAIMO
 SUBDIVISION

- TERRAIN SLOPED AT 0-5%
- TERRAIN SLOPED AT 5-10%
- TERRAIN SLOPED AT 10-20%
- TERRAIN SLOPED AT 20-30%
- TERRAIN SLOPED AT 30% AND GREATER

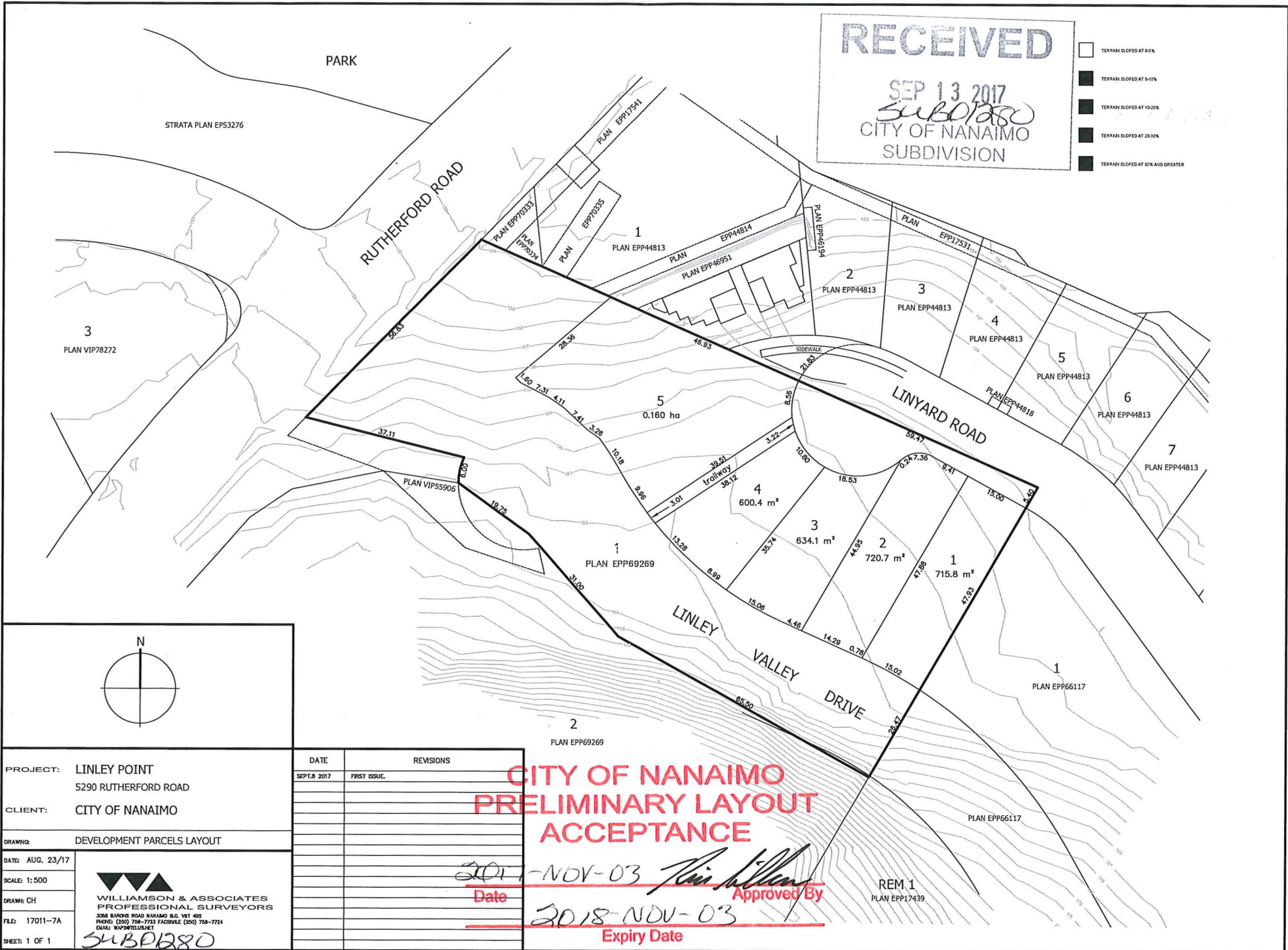

PROJECT:	LINLEY POINT 5290 RUTHERFORD ROAD
CLIENT:	CITY OF NANAIMO
DRAWING:	DEVELOPMENT PARCELS LAYOUT
DATE:	AUG. 23/17
SCALE:	1:500
DRAWN:	CH
FILE:	17011-7A
SHEET:	1 OF 1

DATE	REVISIONS
SEPT. 8 2017	FIRST ISSUE

**CITY OF NANAIMO
 PRELIMINARY LAYOUT
 ACCEPTANCE**

2017-NOV-03 *Chris Hillman*
 Date Approved By
2018-NOV-03
 Expiry Date

REM 1
 PLAN EPP17439

WILLIAMSON & ASSOCIATES
 PROFESSIONAL SURVEYORS
 3305 BURNING ROAD NANAIMO B.C. V1T 4S5
 PHONE: (250) 758-7723 FACSIMILE: (250) 758-7724
 EMAIL: WAPS@TELUS.NET

SUBD 01880